

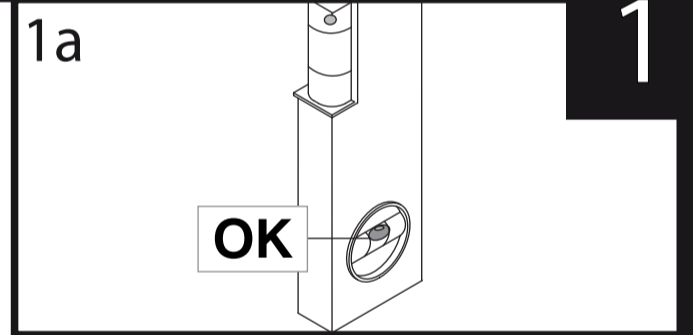

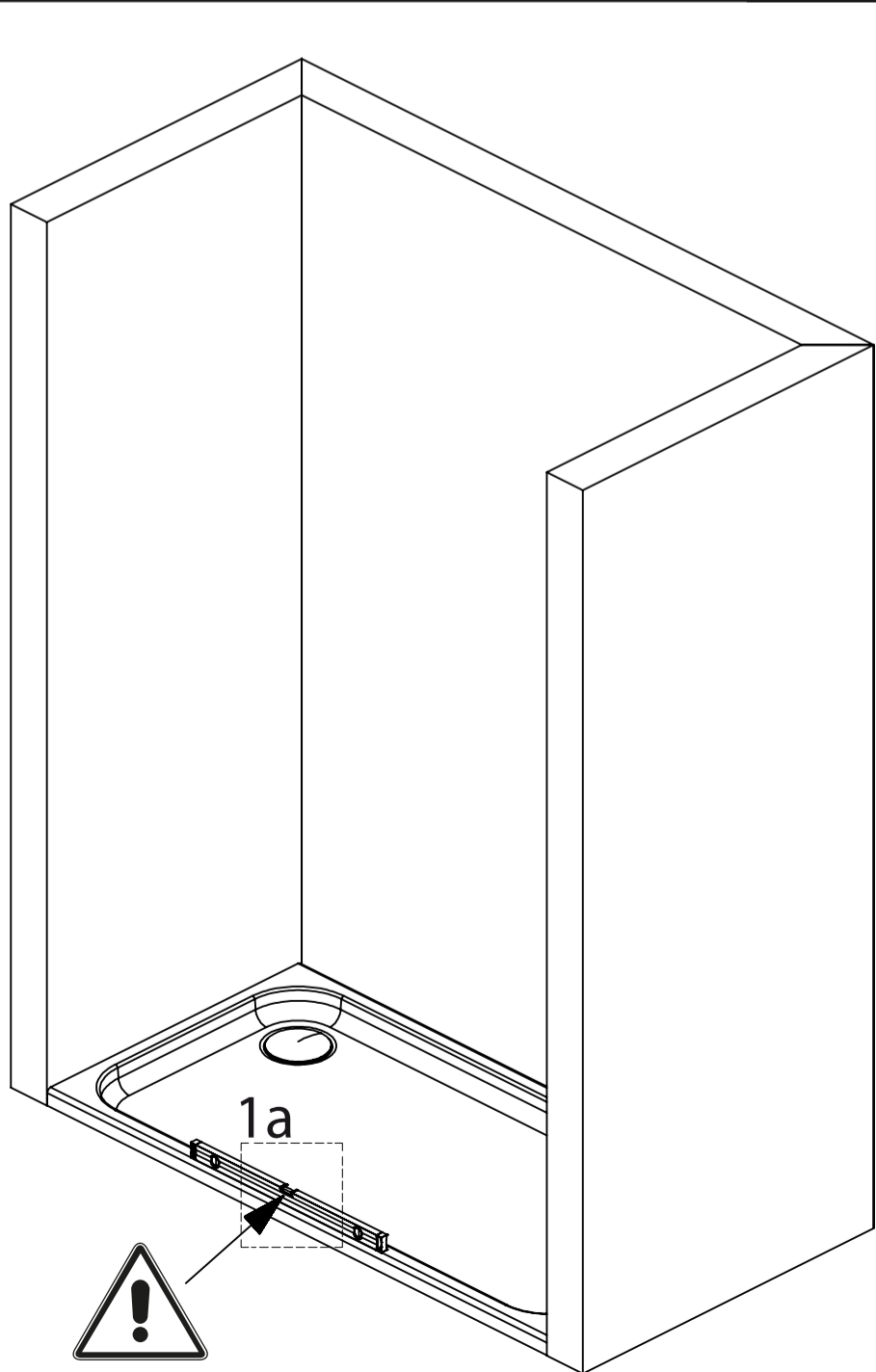

ACCESORIOS

X1 VIDRIO FIJO	X1 VIDRIO HOJA	X2 PERFIL COMPENSADOR PARED [C56110]	X1 PERFIL MARCO FIJO ABATIBLE [M56150]	X1 TIRADOR ASA DOBLE 255mm [AD0255]
X1 PERFIL BASE ESTANQUEIDAD [B51100]	X1 PIEZA PP6 IZQ. EMB. VARILLA PARA HOJA ABATIBLE [HI3017]	X1 PEZA PP6 DCH. EMB. VARILLA PARA HOJA ABATIBLE [HD3018]	X1 TAPA PP6 PERFIL COMPENSADOR 5611 [TC3000]	X4 TAPA EMB. TORNILLO PERFIL COMPENSADOR [TE3012]
X1 PIEZA TAPA SUPERIOR PERFIL [PS3006]	X1 PIEZA TAPA INFERIOR PERFIL 5015 [PI3007]	X1 PIEZA SOPORTE SUPERIOR PERFIL 5612 [PS3001]	X1 PIEZA SOPORTE INFERIOR PERFIL 5612 [PI3002]	X1 PIEZA TAPON SUPERIOR PERFIL 5613 [TS3008]
X1 PIEZA TAPON INFERIOR PERFIL 5613 [TI3009]	X1 PERFIL MAGNETICO N-S ã PVC CRISTAL 6mm [P12470]	X1 PERFIL MAGNETICO N-S ã PVC CRISTAL 6mm [P12480]	X1 VIERTEAGUAS PVC CRISTAL 6mm [V11540]	X1 INFERIOR PVC CRISTAL ABATIBLE MINI [J12880]
X1 JUNTA PUERTA ABATIBLE PVC CRISTAL [J10120]	X1 KIT BARRA UNION V/PARED 45 cm [KB045I] Cog. Izq. [KB045D] Cog. Dch.	X6 TACO 8mm	X6 ARANDELA DIN125 M6 INOX [A01256]	X6 TORNILLO INOX DIN7982 4.8*32 [T04832]
X4 TORNILLO INOX DIN7982 4.2*16 [T04816]				

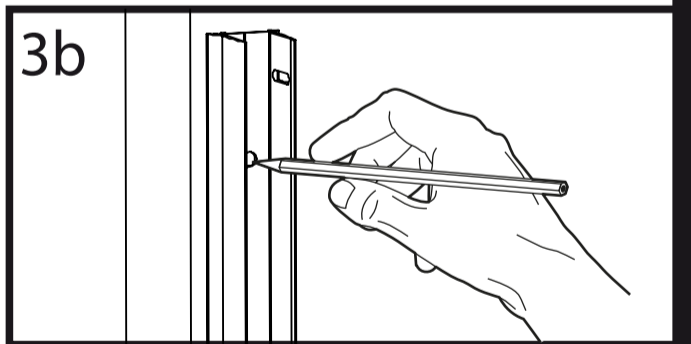
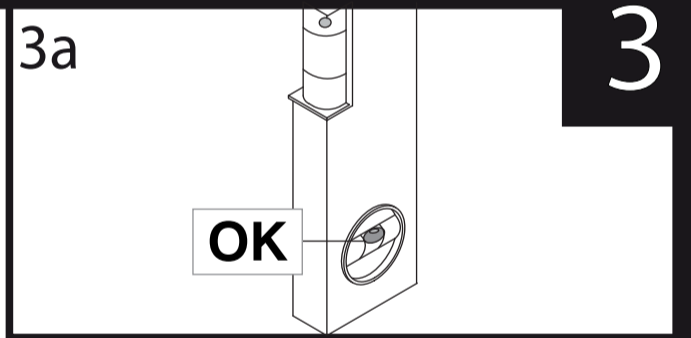
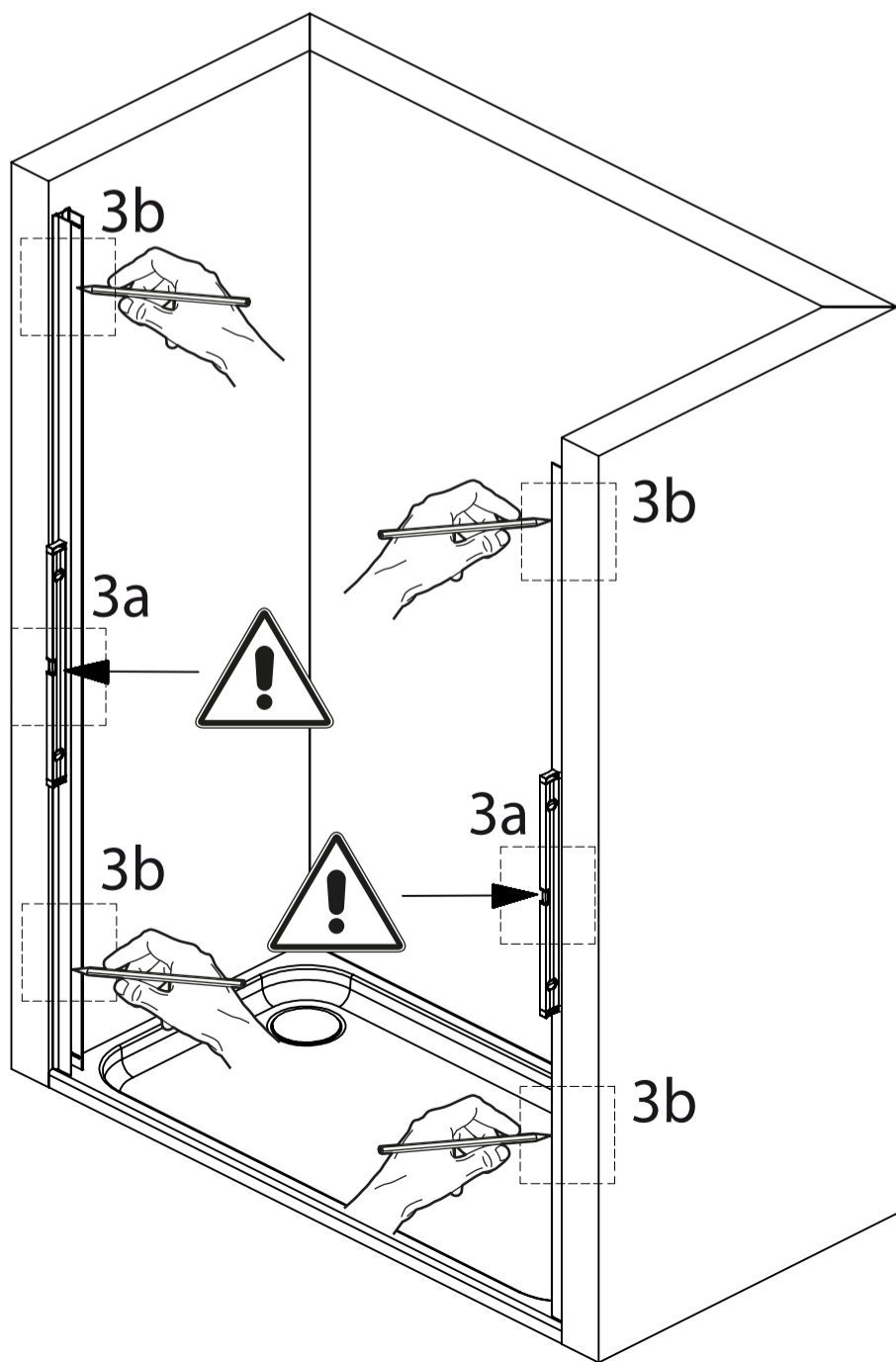
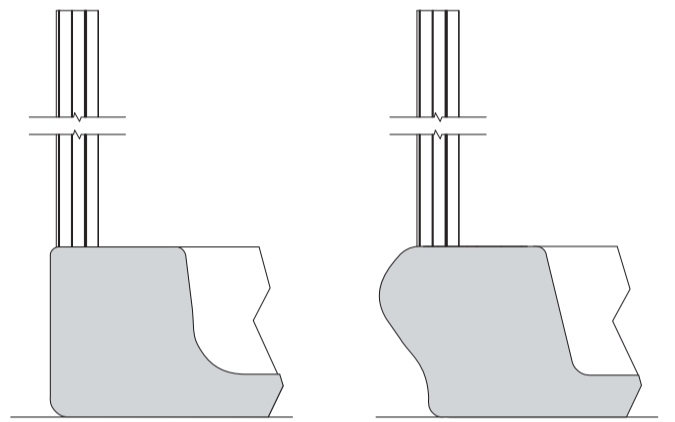
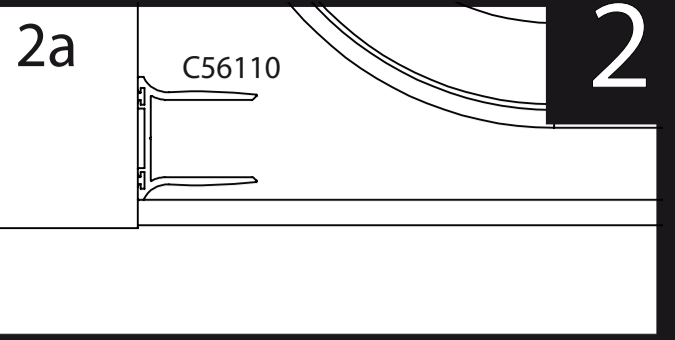
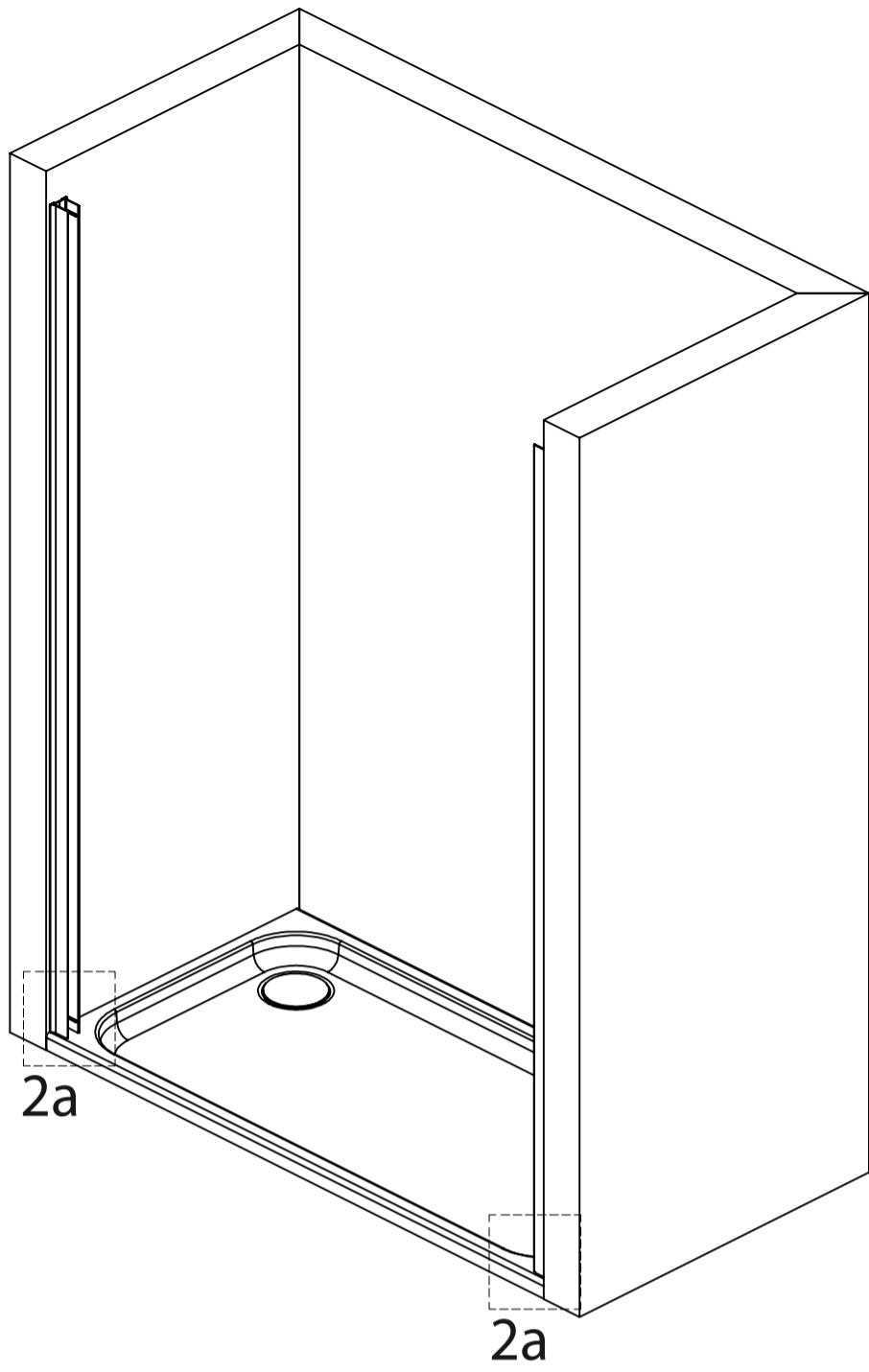
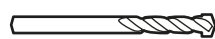



-  BROCA 8 mm
-  TACO 8 mm
-  4.8x32mm T04832
-  Arandela M6 A01256

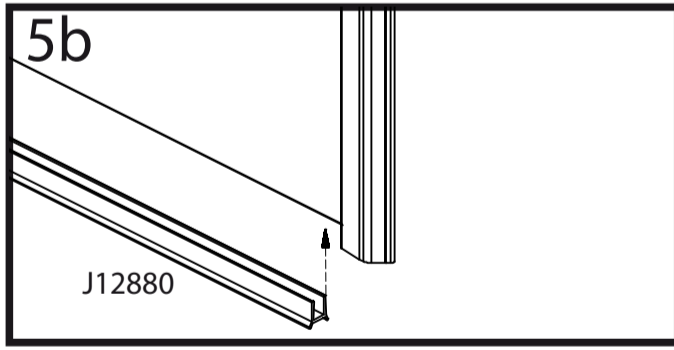
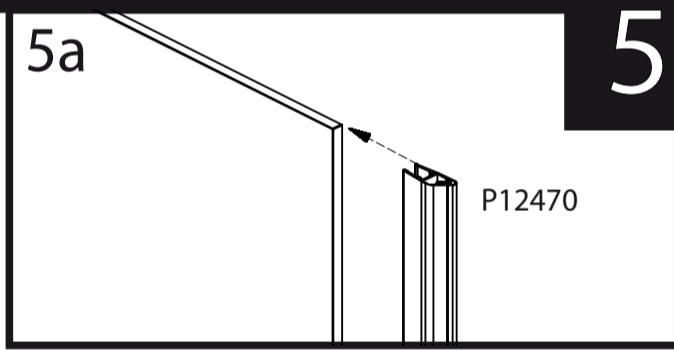
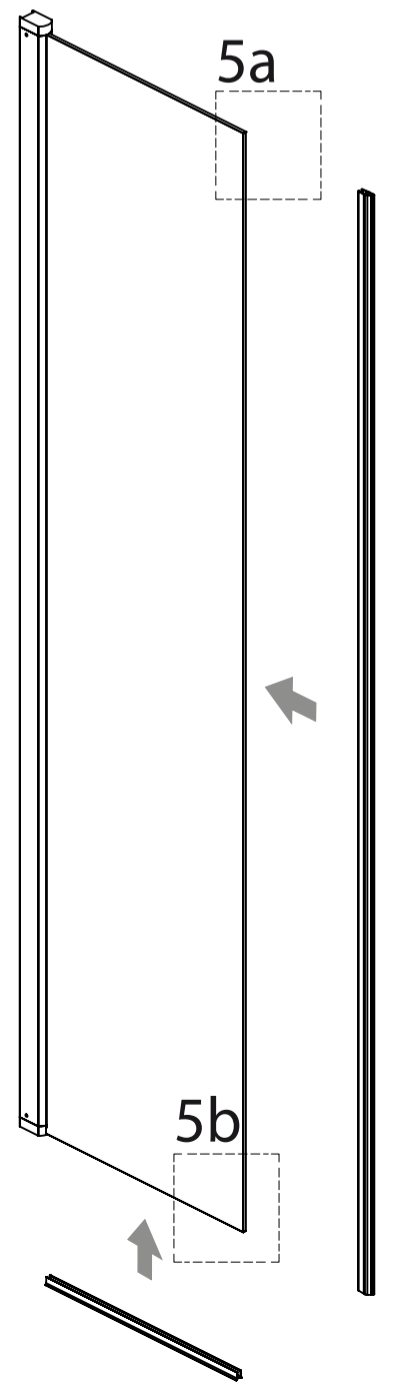
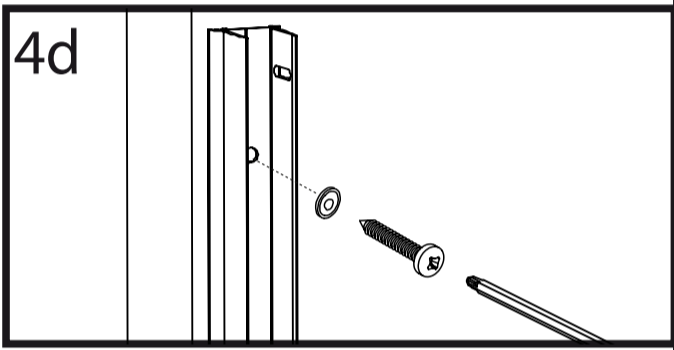
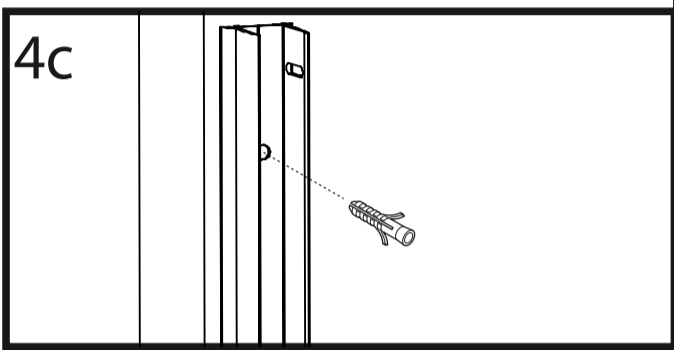
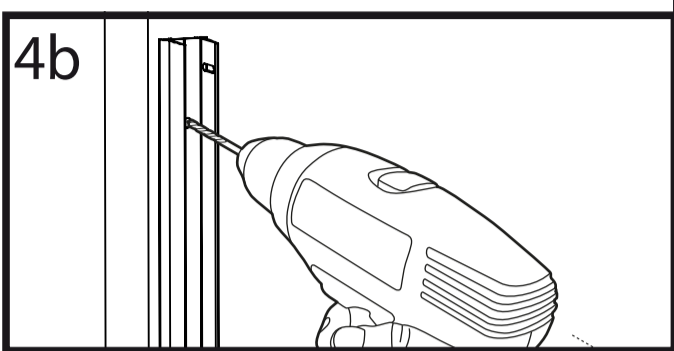
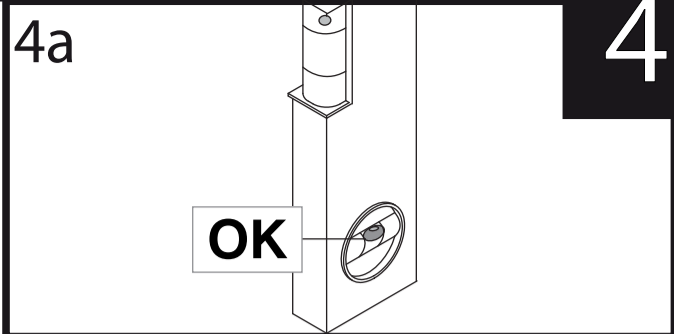
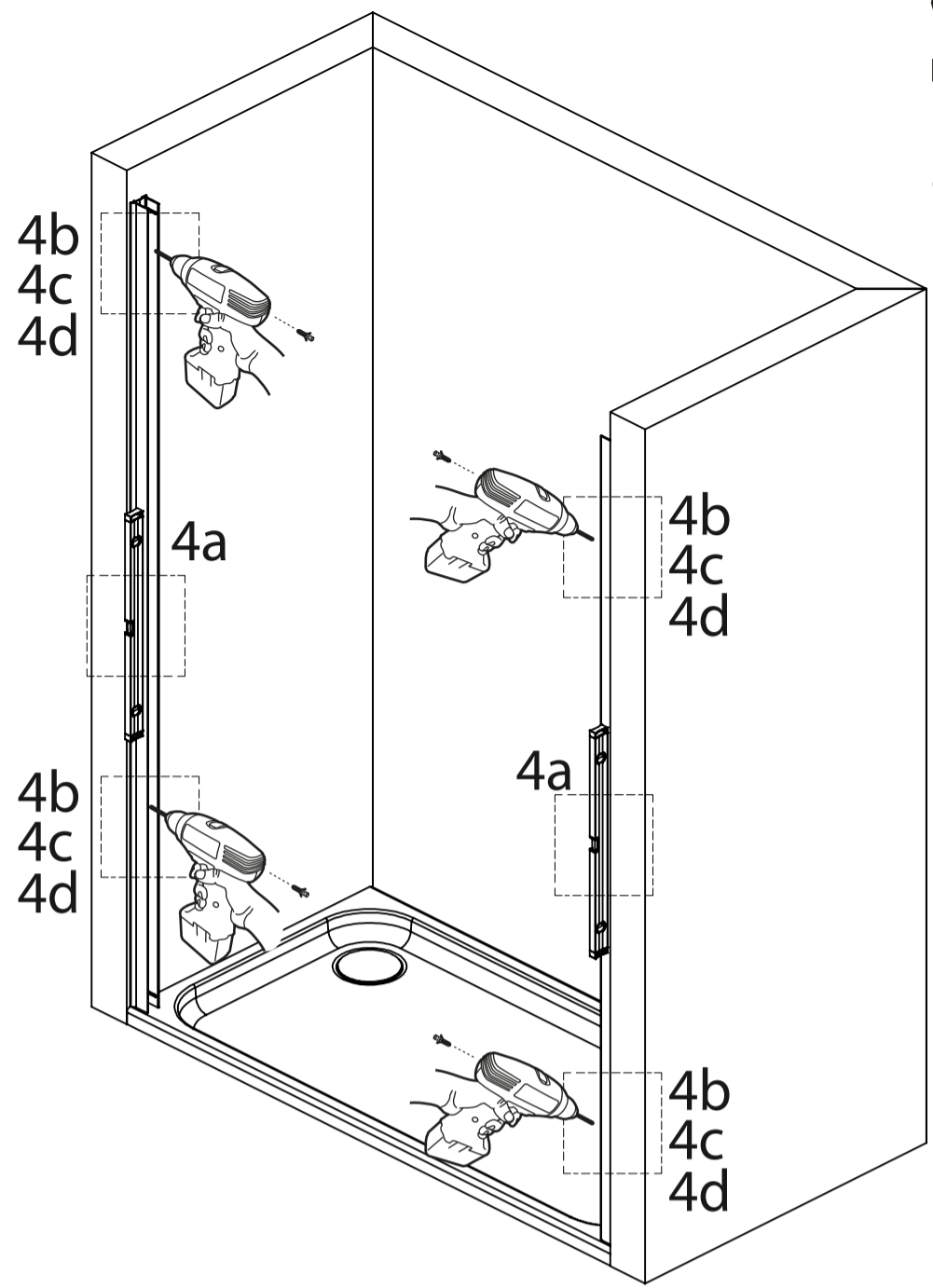

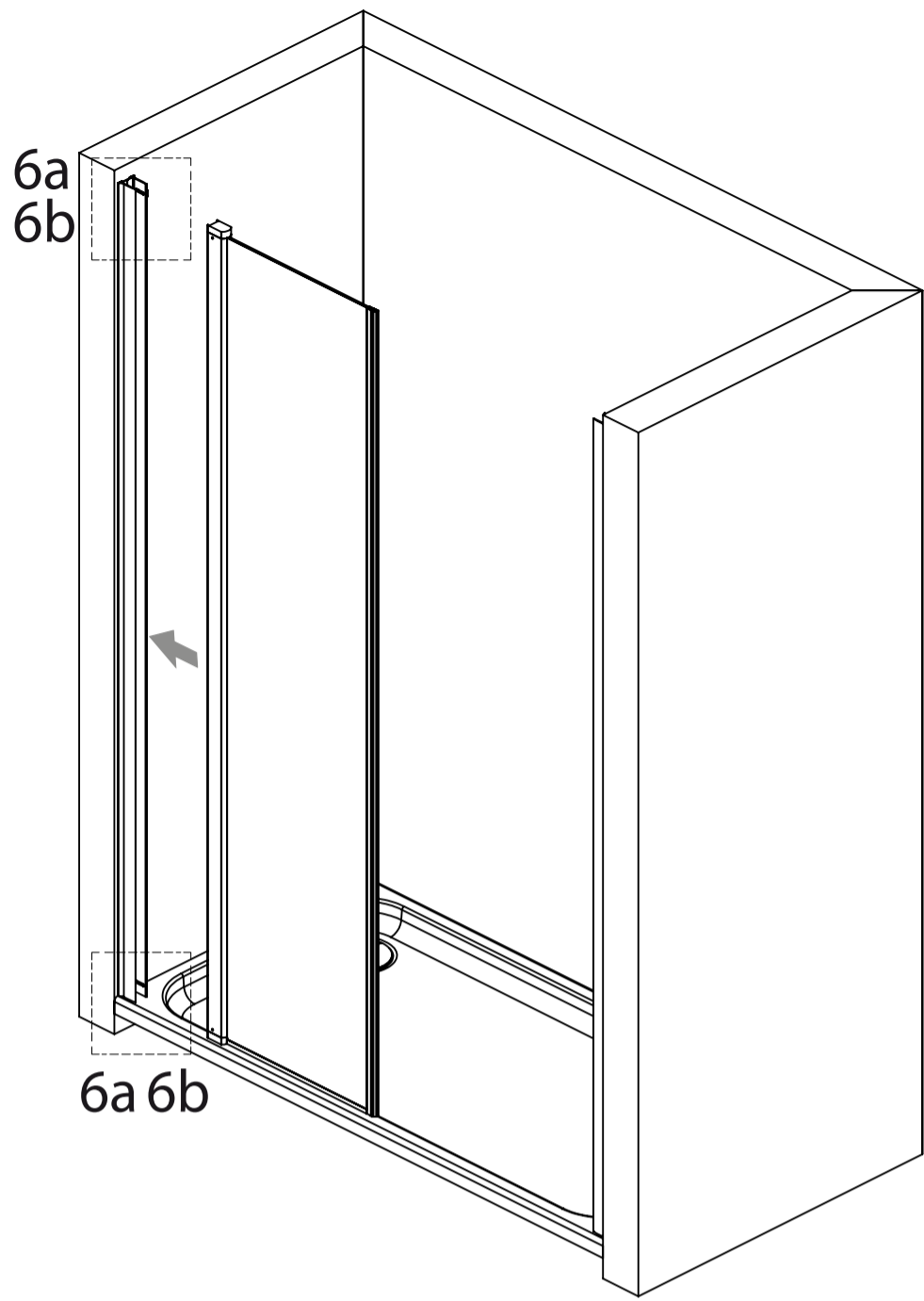

 4.8x16mm T04816

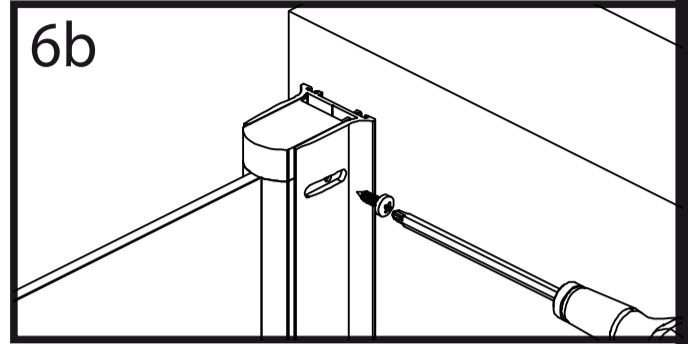
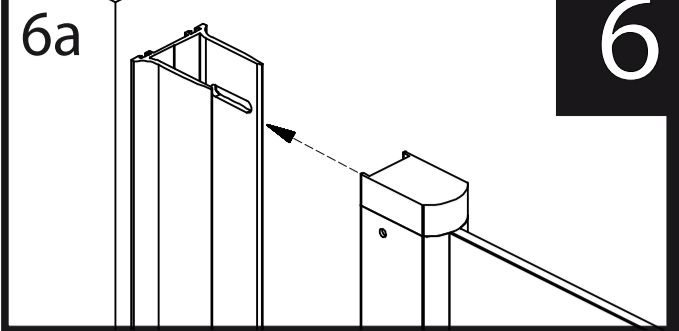

¡SOLO PRESENTAR TORNILLO,
NO REALIZAR APRIETE FINAL!

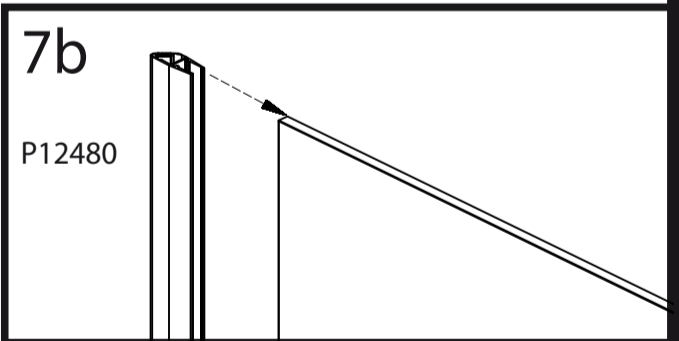
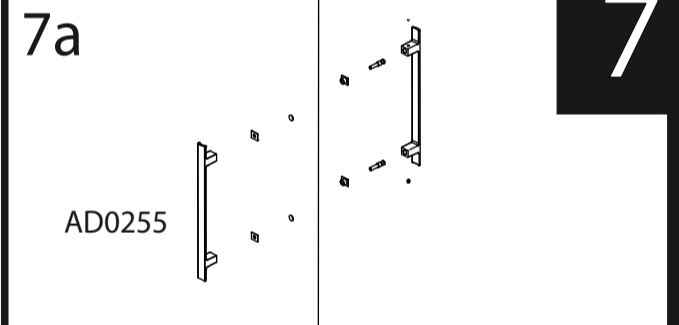
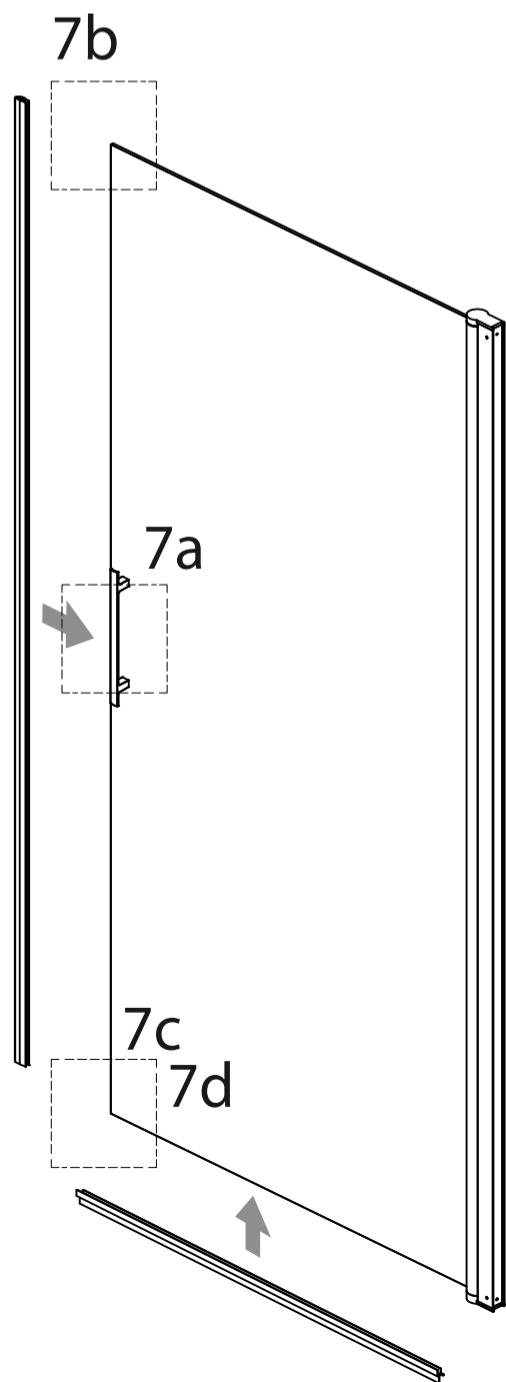

4.8x16mm T04816

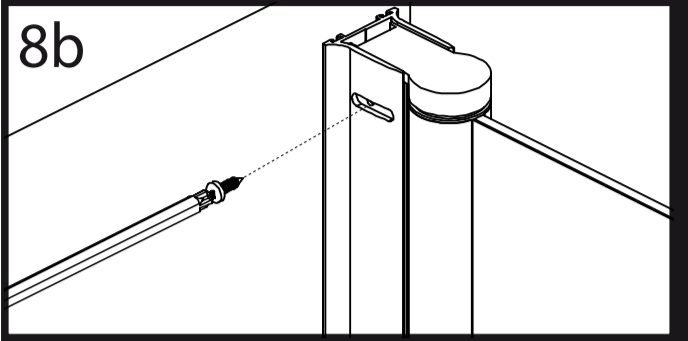
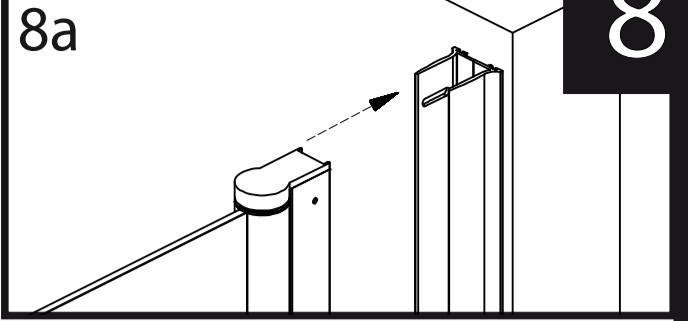
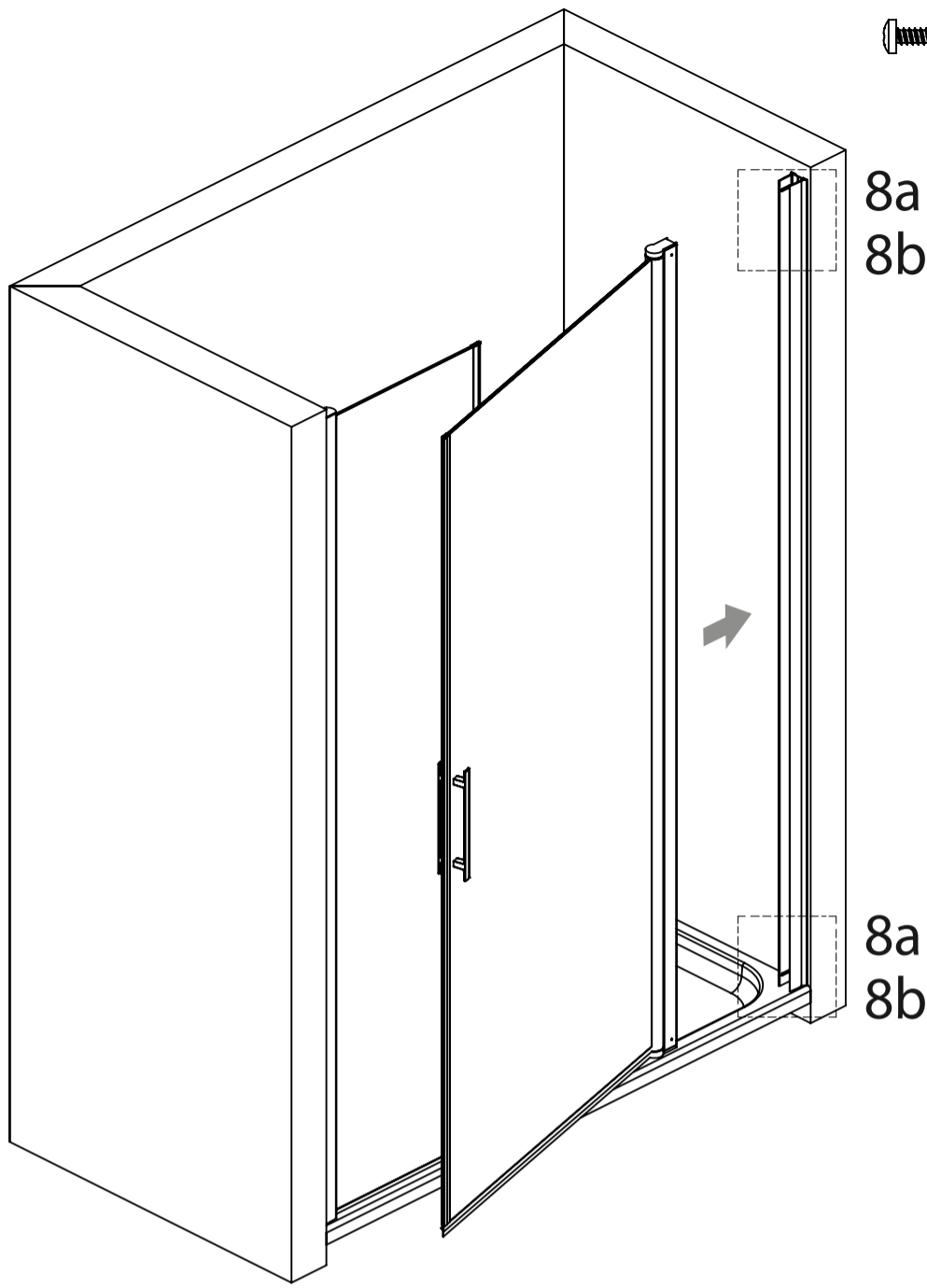

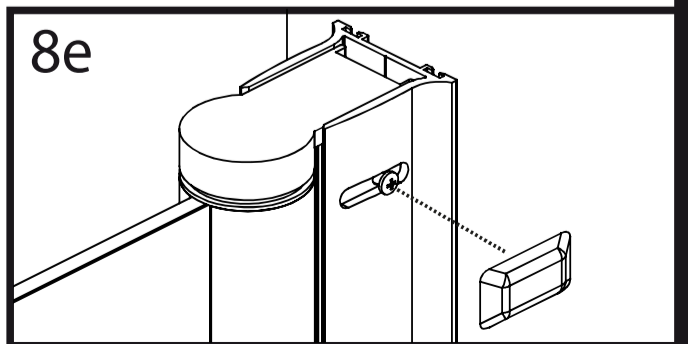
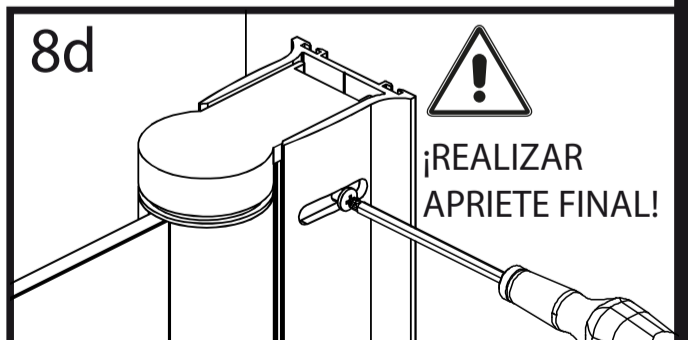
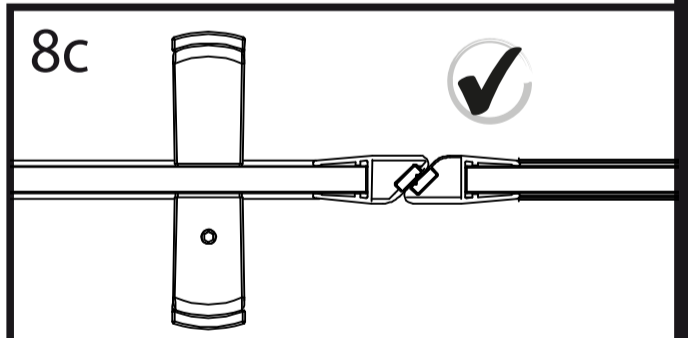
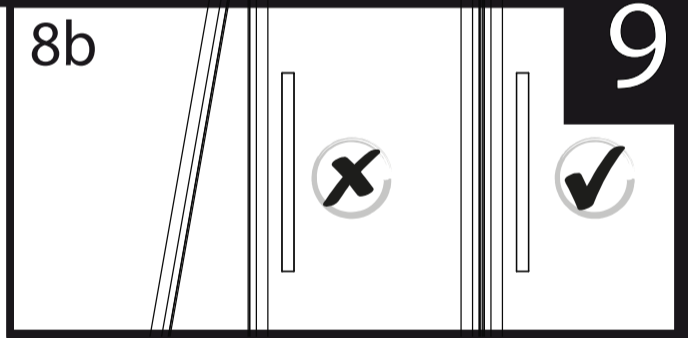
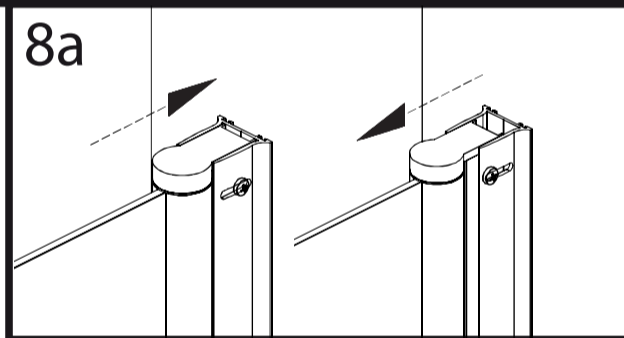
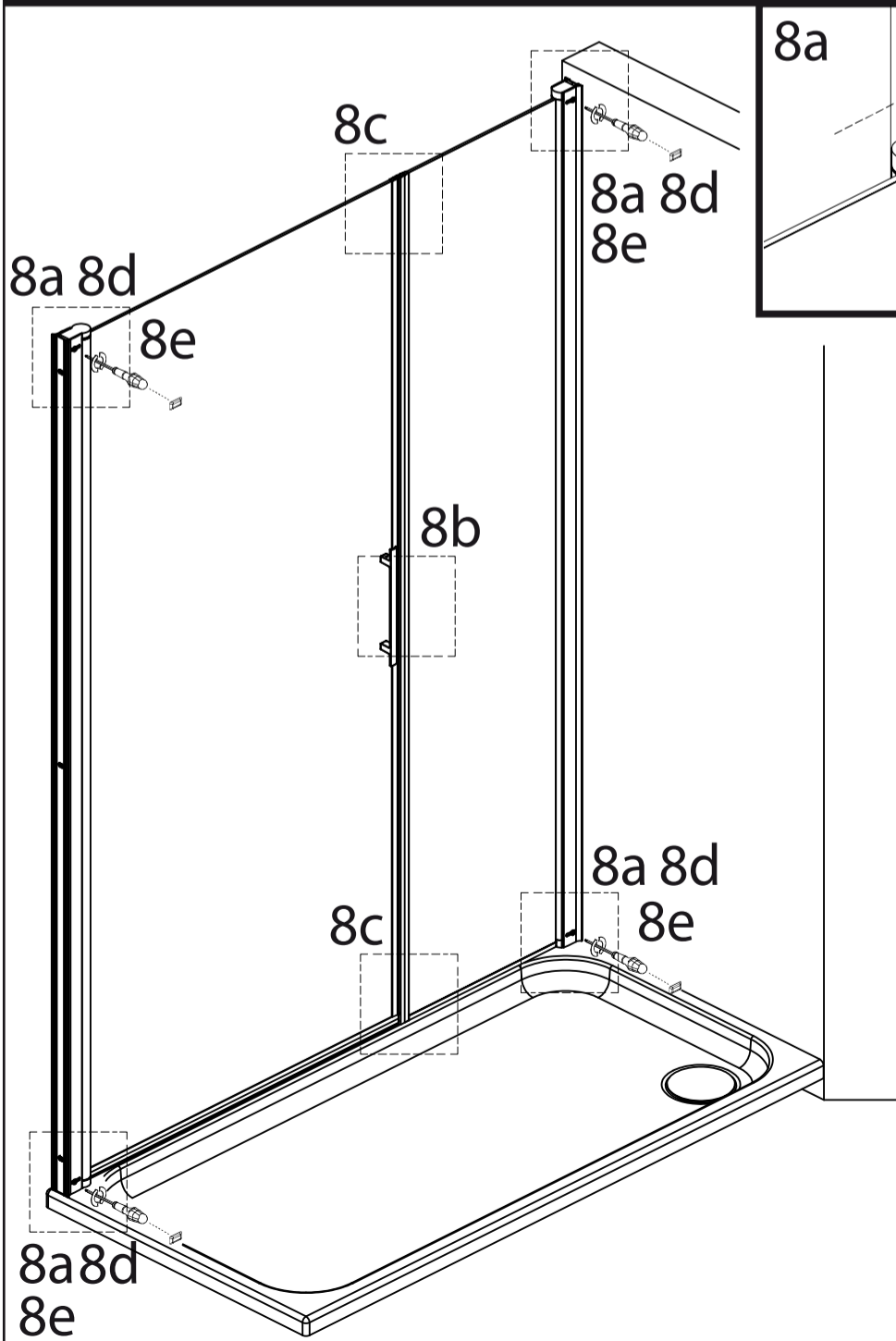

¡SOLO PRESENTAR TORNILLO, NO REALIZAR APRIETE FINAL!



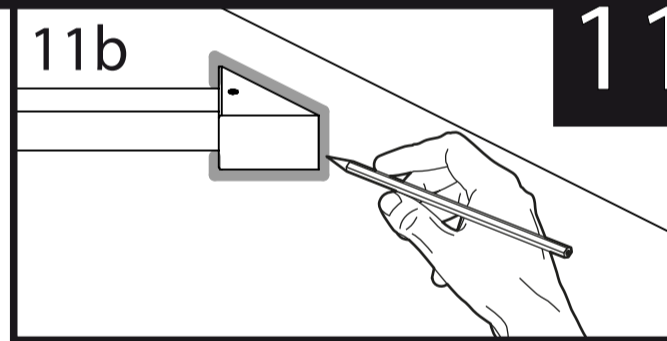
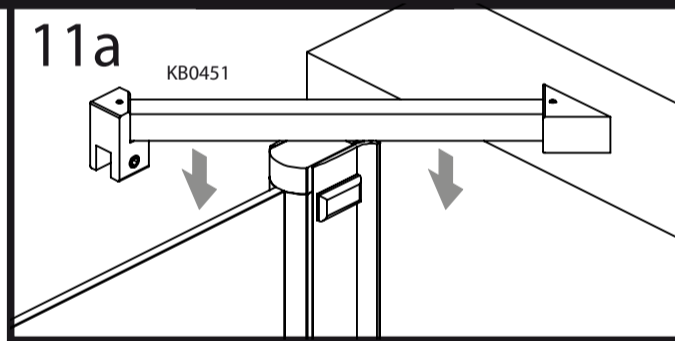
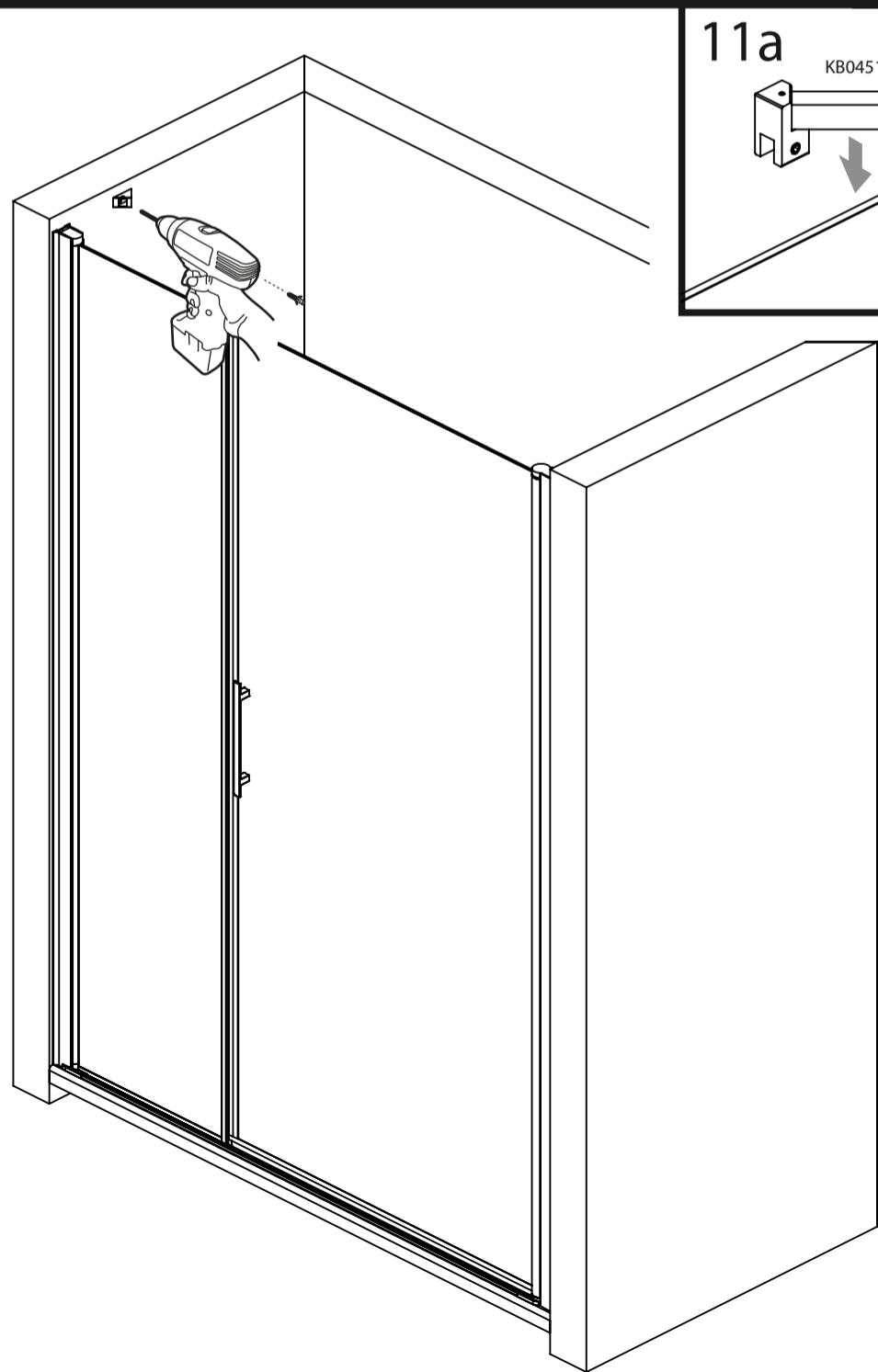
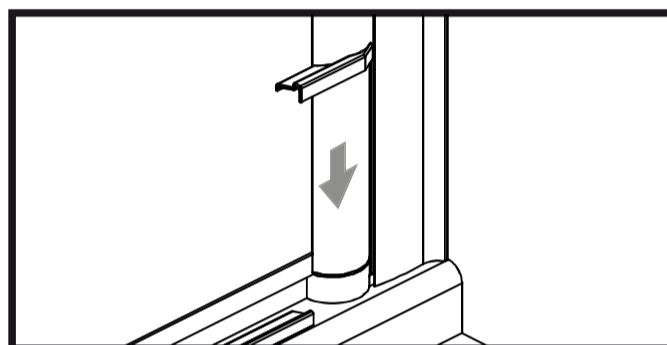
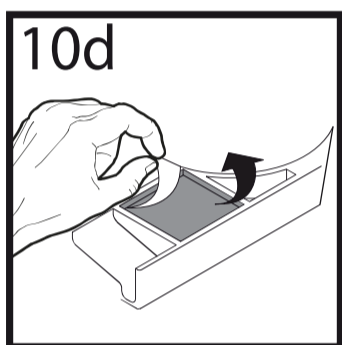
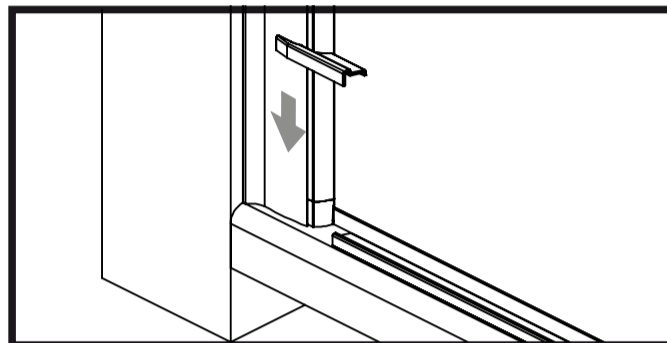
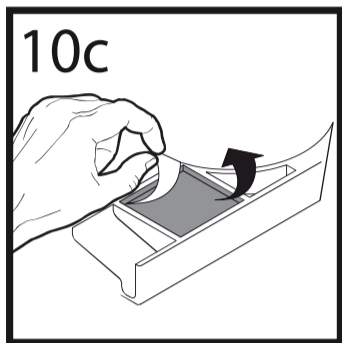
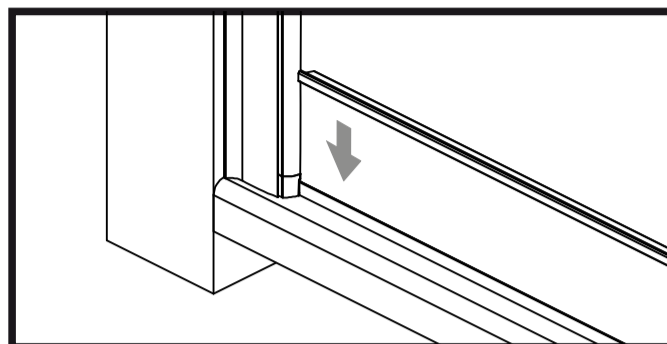
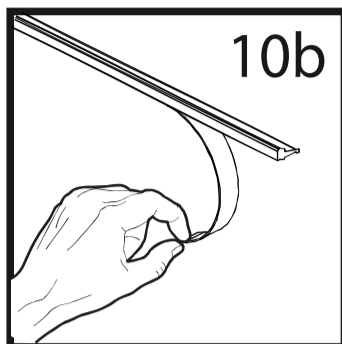
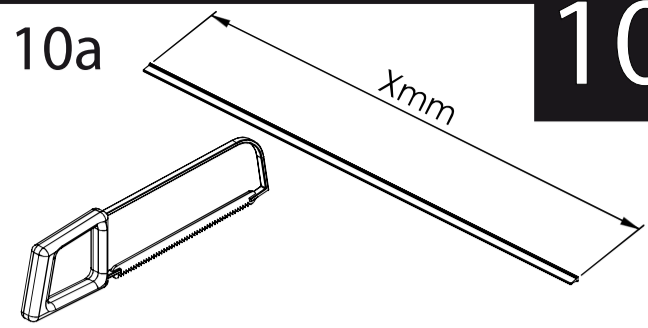
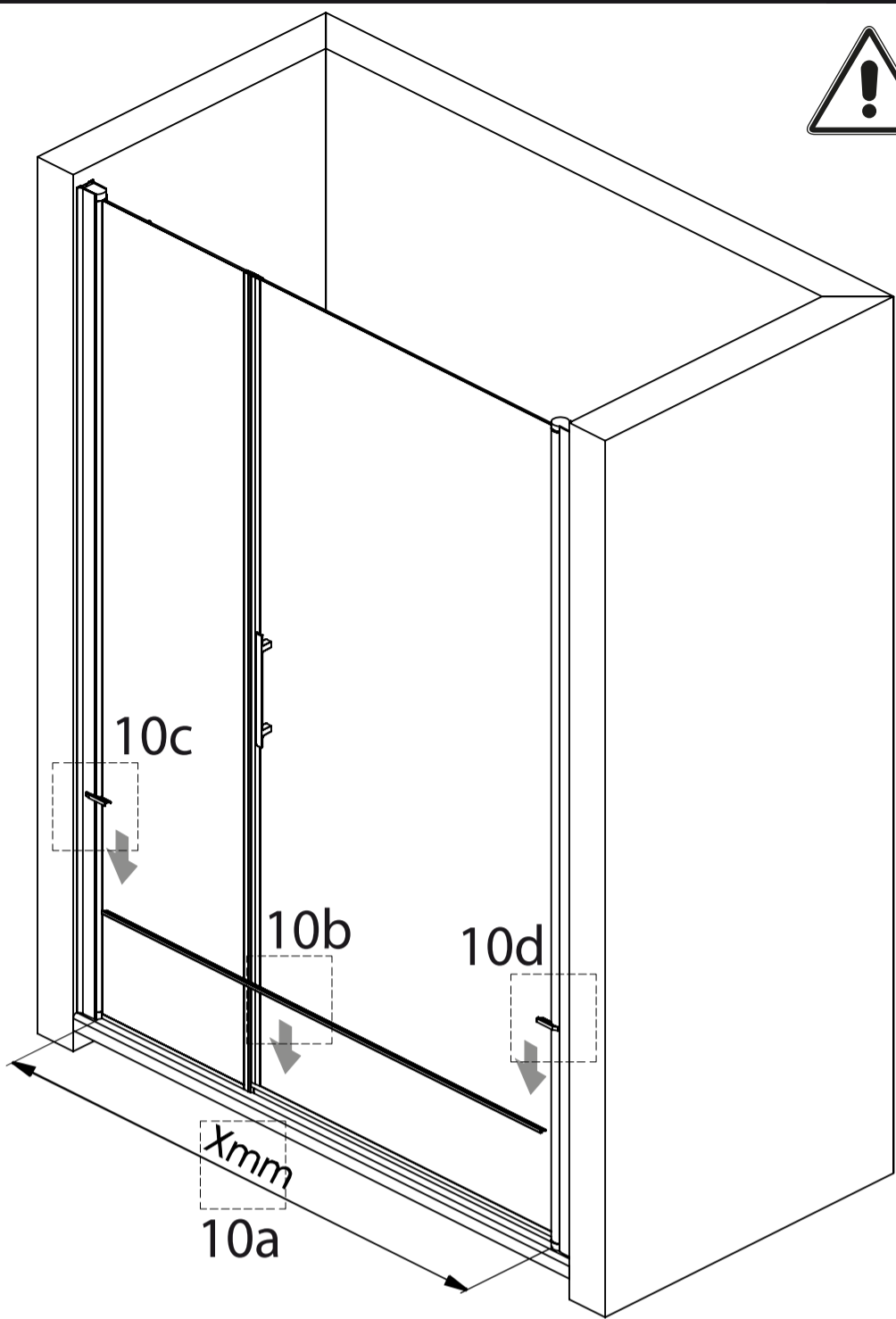

¡VERIFICAR LONGITUD DE VIERTEAGUAS CON EMBELLECEDORES!

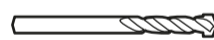

-  BROCA 6 mm
-  TACO 6 mm
-  4.8x32mm T00440

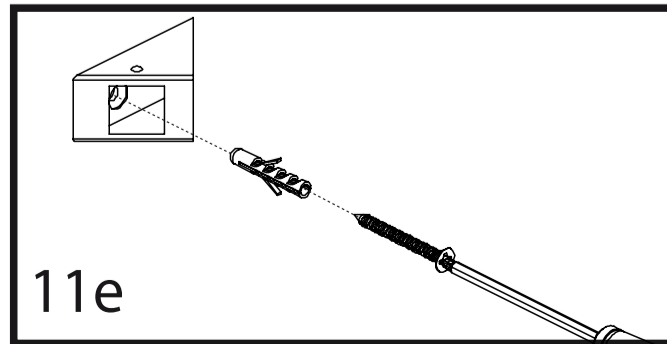
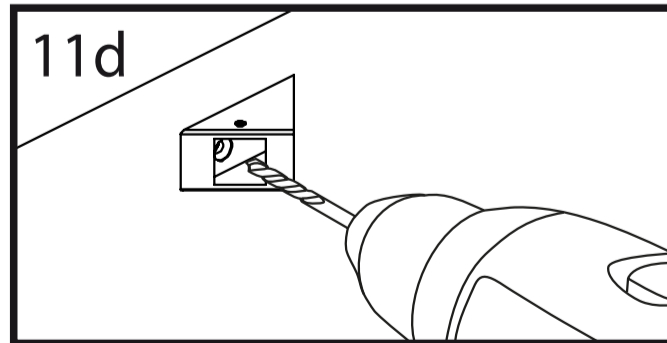
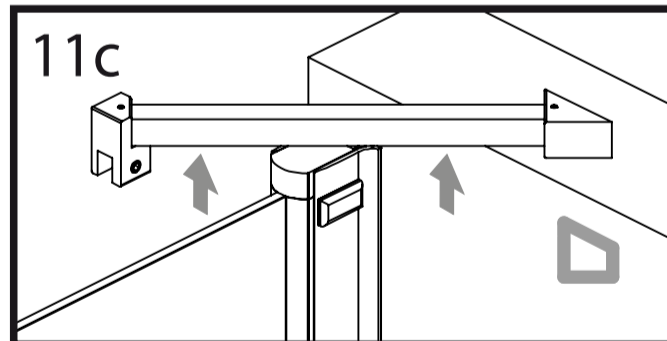

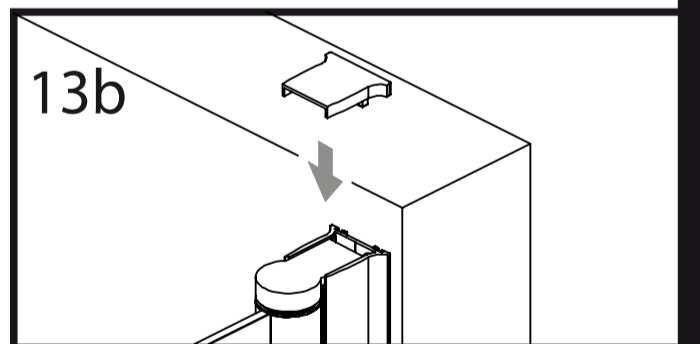
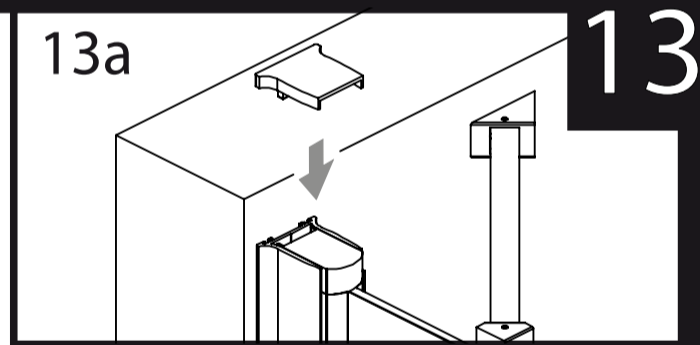
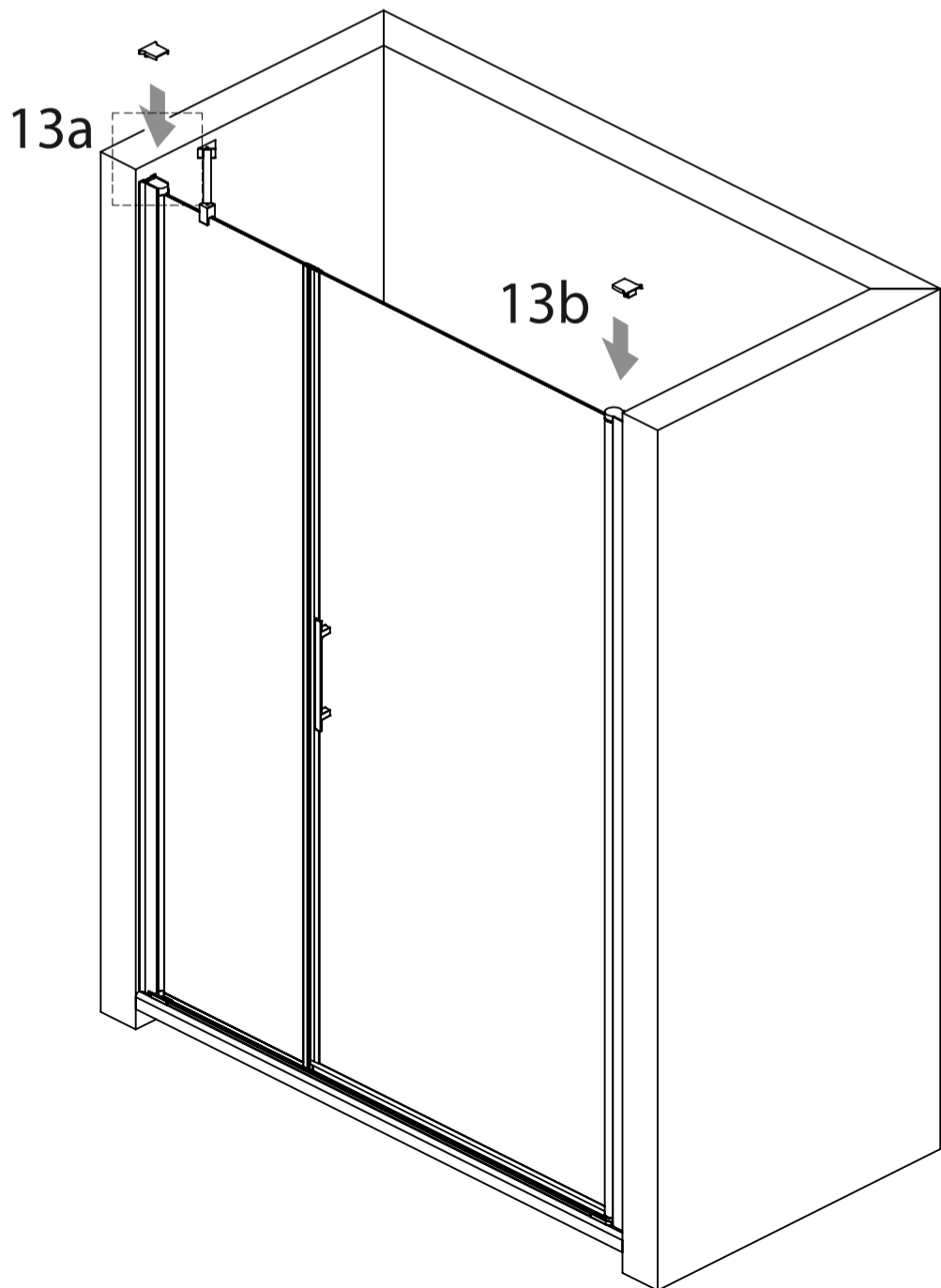
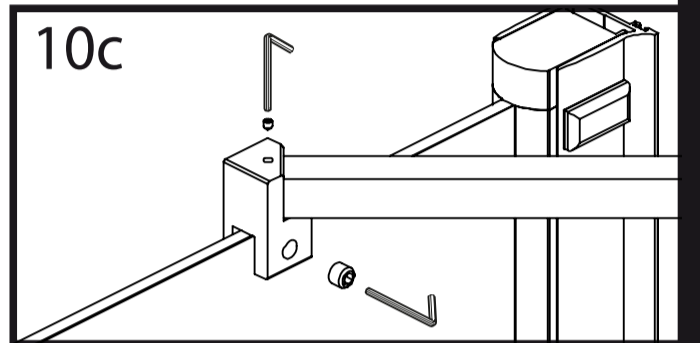
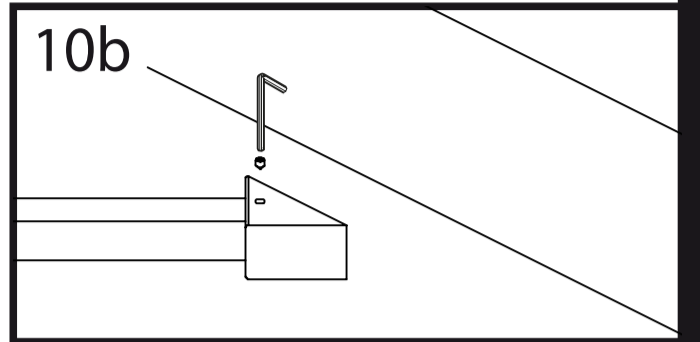
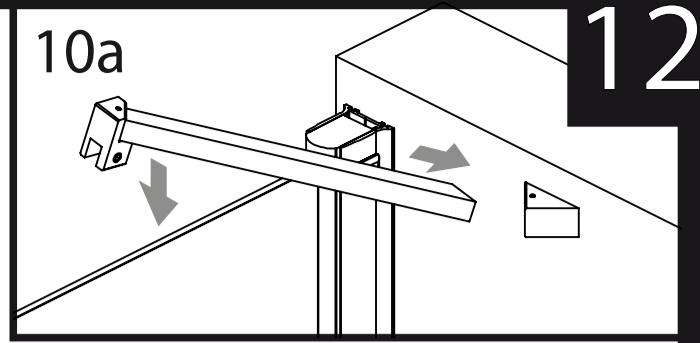
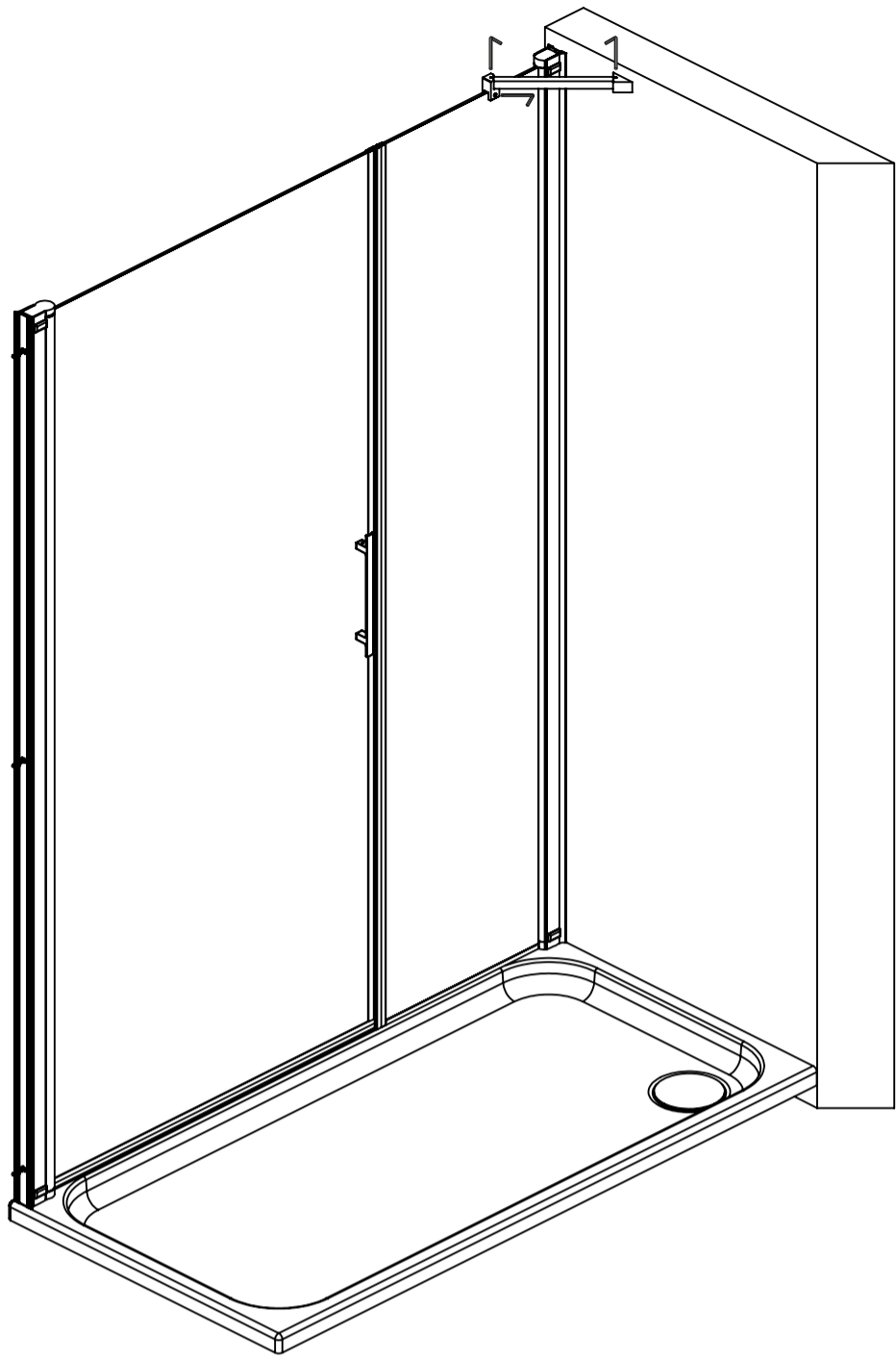

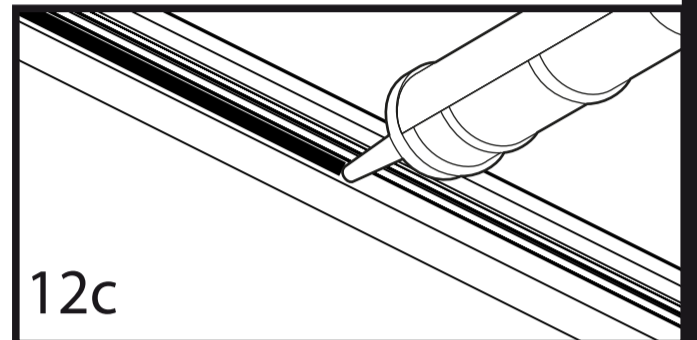
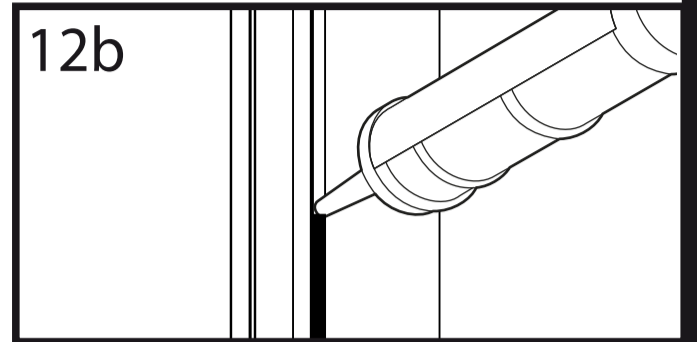
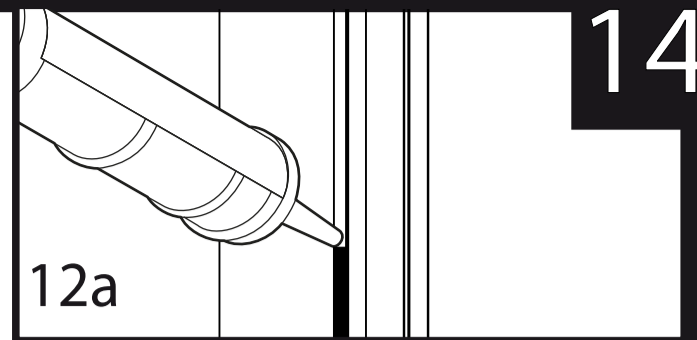
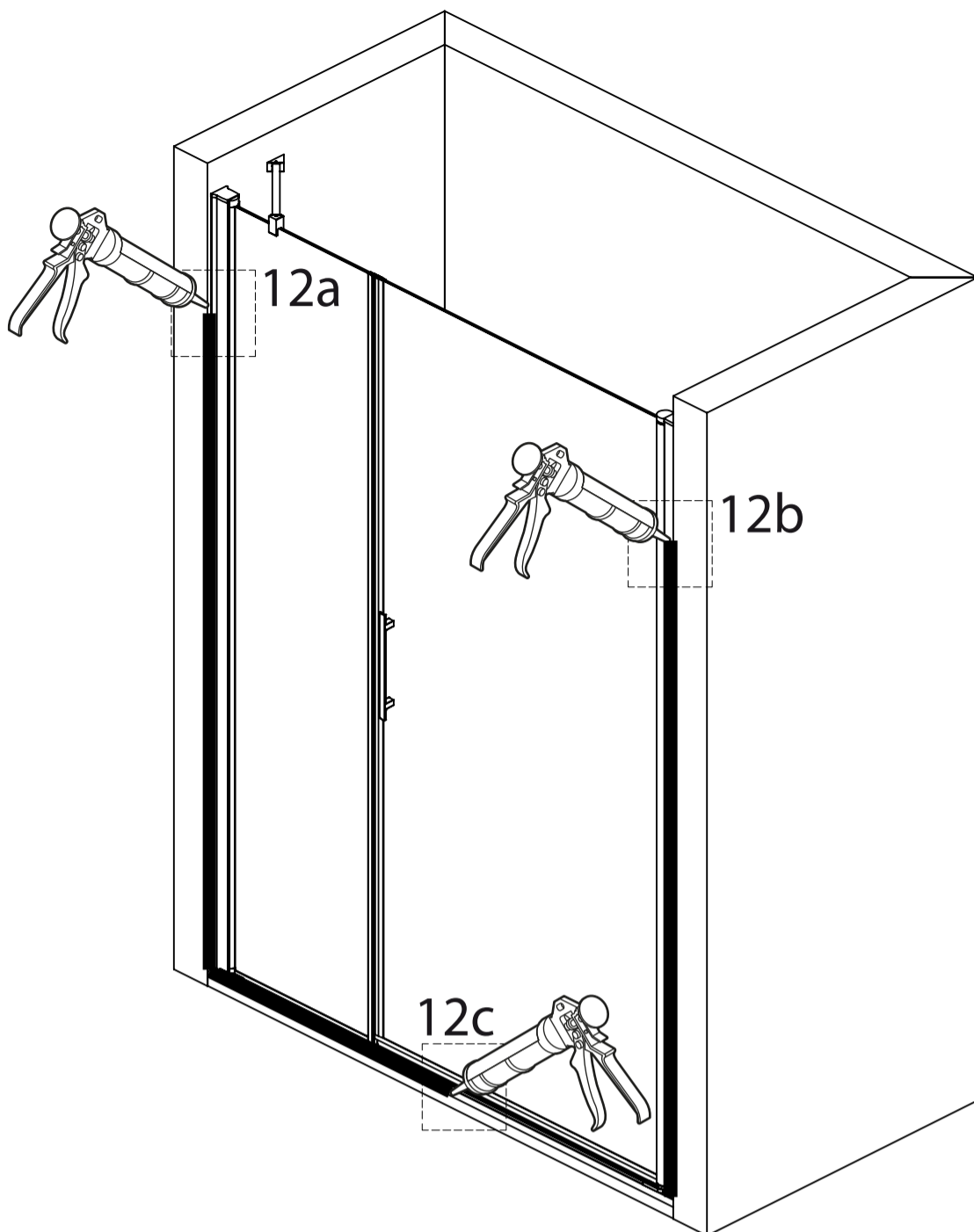

! LIMPIEZA

Para el cuidado de los productos Hidroglass y mantenerlos en perfecto estado, se aconseja secar con un paño o bayeta los accesorios (Bisagras y componentes), que estén en contacto con el agua, así evitaremos que se deposite la cal en los accesorios, después diluir en un paño un poco de jabón líquido con agua para limpiarlo perfectamente.

ATENCIÓN

No emplear nunca, detergente con sustancias abrasivas o con base ácida, amoníaco, acetona, lejía, ácidos varios, vinagre puro o esponjas abrasivas. El uso de los productos, pueden deteriorar irremediabilmente la superficie de los accesorios e Hidroglass no se hará responsable.

CONSEJOS PARA EL MANTENIMIENTO Y LIMPIEZA

La cal y la suciedad depositada en los accesorios se podrán lavar con una solución de agua y vinagre (concentración máxima de vinagre 15%, que sería 15 ml de vinagre en un litro de agua) después lavar con agua y jabón y aclarar.

Care products Hidroglass and keep in perfect condition, it is advisable to dry with a cloth or cloth accessories (hinges and components), which are in contact with water, thus avoiding the deposit of lime in the accessories, then dilute cloth in a little liquid soap with water to clean perfectly.

ATTENTION

Never use, detergent based abrasives or acid, ammonia, acetone, bleach, various acids, pure vinegar or scouring pads. The use of the products, can damage the surface beyond Hidroglass accessories and will not be responsible.

TIPS FOR MAINTENANCE AND CLEANING

The lime and dirt deposited on accessories may be washed with a solution of water and vinegar (maximum concentration of 15% vinegar, that would be 15 ml of vinegar in a quart of water) after washing with soap and water and rinse.

Para produtos de cuidados Hidroglass e mantê-los em bom estado, recomendo secar com um pano ou um pano acessórios (dobradiças e componentes), que estão em contato com a água, por isso evite cal é depositado nos acessórios, em seguida, diluir em um pano um pouco de sabão líquido com água para limpá-lo perfeitamente.

ATENÇÃO

Nunca use, detergentes abrasivos ou a base de ácido, amônia, acetona, água sanitária, vários ácidos, vinagre puro ou esponjas abrasivas. O uso dos produtos, pode danificar a superfície além do reparo e acessórios Hidroglass não deve ser responsabilizada.

DICAS PARA MANUTENÇÃO E LIMPEZA

Cal e sujidade depositada sobre os acessórios podem ser lavadas com uma solução de água e vinagre (concentração máxima de 15% de vinagre, que seria de 15 ml de vinagre em um litro de água), em seguida lavar com água e sabão e enxaguar.